

Product Code	Description
JC273-W	10AX 250V 3 Gang 1 Way Switch



JC273-W-LWH



Product back view

Technical Specification

- Rated Voltage: 250VAC, 50/60Hz
- Rated Current: 10AX
- Recommended wire size:
1.5mm² ~ 2.5mm²
- Isolating Gap Contact: 3mm nominal
- Contact Material: Silver-Nickel Alloy
- Operating Temperature:
-5°C to +40°C
- IP Rating: IP4X
- No. of operations:
40,000 at 10 Amp.
- Fix Center: 60.3mm
- Fix Screws:
M3.5 x 0.6 x 25mm±

With Lavina '95 Frame: JC1401

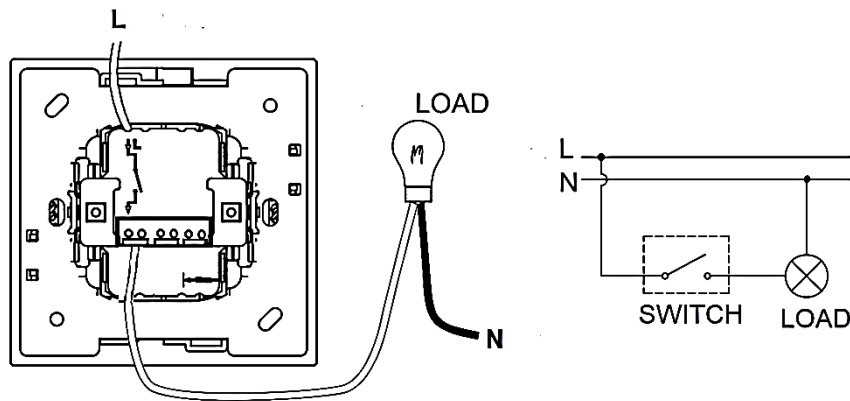

- Dimensions: 95x95x10mm (WxHxD)
- Mounting box: >40mm depth
 - J1040, flush mounting, plastic
74.5 x 74.5 x 42mm (W x H x D)
 - M1050, flush mounting, metal
75.5 x 64 x 50mm (W x H x D)
- Comply to Standards:
 - IEC 60669-1
 - BS EN 60669
 - GB/T 16915.1

Typical Switch Connection:

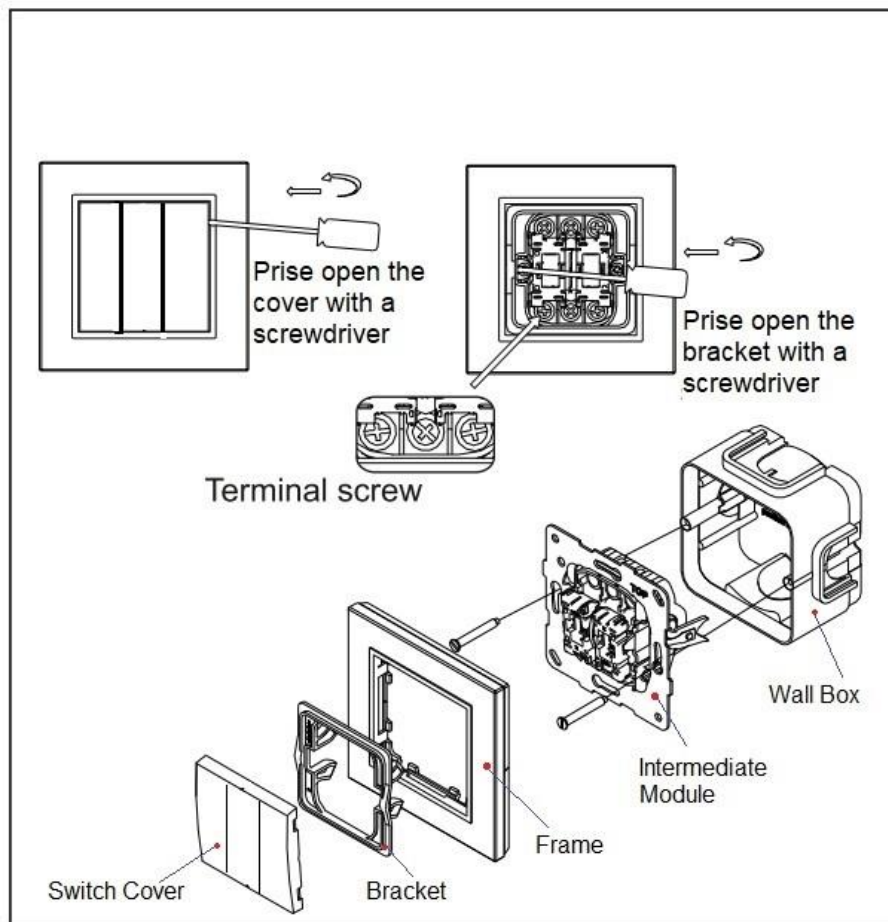

Mounting Diagram (for reference)



Product Code	Colour
JC273-W-LWH	 Matt White
JC273-W-LBL	 Matt Black
For other colours, please contact T&J Sales representative	